

ZXL™ HG™ SteelBinder®

Features and Benefits

- Fastener is designed to attach long-life metal roof panels such as GALVALUME to structural steel joists up to .500" thick.
- 5/16" Cupped HWH ZAMAC Zinc-Aluminum Alloy provides lifetime protection against red rust on the head & washer face. A written warranty is available upon request.
- The head & washer face captures the rubber EPDM washer even when driven at an angle & are designed to maximize Pull over strength.
- For structural steel applications, a screw gun with RPM under 2000 is recommended for best performance.

FOR PROPER INSTALLATION, THE USE OF IMPACT DRIVERS ARE NOT RECOMMENDED FOR POWDER COATED OR ANY WET PAINTED FASTENER.

PULLOUT & PULLOVER VALUES ARE DETERMINED IN THE ST FASTENING SYSTEMS ENGINEERING LABORATORY USING STEEL PANELS/FRAMING & WOOD DENSITIES WHOSE STRUCTURAL PROPERTIES ARE FOUND IN PRESENT DAY PRODUCTS.

SIZE	CARTON QTY.	WEIGHT/M
12-24 x 1-1/4"	2000	25.8

PULL OVER STRENGTH LBS. ULT.

SUBSTRATE	GAUGE	THICKNESS	VALUE
HRS PRIMED ONLY	14	.075	924
HRS PRIMED ONLY	12	.105	1627
HRS PLATE	3/16"	.187	2240
HRS PLATE	1/4"	.250	2240

PULL OVER STRENGTH LBS. ULT.

SUBSTRATE	GAUGE	THICKNESS	VALUE
AZ55 Galvalume	29	.014	637
AZ55 Galvalume	26	.018	1045
AZ55 Galvalume	24	.024	1303
AZ55 Galvalume	22	.030	1958

NOTES

- HRS (Hot Rolled Steel)
- Pull over values calculated with EPDM rubber washer assembled to cupped head screw with .555" washer face.
- All strength values shown are ultimate values, express in LBS. Apply an appropriate safety factor to obtain design limits.
- ** The value tabulated is the force at which the ZXL head breaks from the carbon steel body.

6357 Reynolds Road Tyler, Texas 75708 | P.O. Box 4515, Tyler, Texas 75712 | 800-352-4864 | 800-352-3940 Fax
9950 Princeton Glendale Rd. Cincinnati, OH 45246 | 800-944-8920 | 800-352-3940 Fax
Copyright 2017 © ST Fastening Systems, Division of The Hillman Group. All rights reserved.



The Zinc-Aluminum alloy HWH prevents red rust from ever starting. ST Fastening Systems spring retainer sockets are recommended. ST Fastening Systems sockets are designed to allow for the added thickness of the powder coat.

No Red-Rust Guaranteed!

HEAD STYLE	5/16" CHWH
POINT DIAMETER	.199/.195
MAJOR DIAMETER	.215/.209
MINOR DIAMETER	.164 REF.
WASHER FACE DIAMETER	.630
HEAD ACROSS FLATS	NOM .312"
NOM. TENSILE STRENGTH	2240** LBS.
MIN. TORSIONAL STRENGTH	100 IN-LBS.
NOM. SHEAR STRENGTH	1999 LBS.

Applications

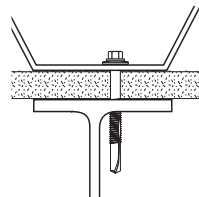

WWW.STFASTENINGSYSTEMS.COM A Division of The Hillman Group