

HG[™] SteelBinder[®]

Features and Benefits

- Fastener lengths over 1-1/4" are designed to penetrate steel thickness up to .500".
- Thread to point ratio engineered to provide maximum pull out strength in heavy gauged steel.
- EPDM rubber is vulcanized to steel washer. Moisture has no place to penetrate. The washer provides a secure seal even when driven at an angle.
- Applications include metal deck to structural steel or bar joists, & retrofit clips to structural steel.
- Fastener is also available without a bonded sealing washer.

FOR PROPER INSTALLATION, THE USE OF IMPACT DRIVERS ARE NOT RECOMMENDED FOR POWDER COATED OR ANY WET PAINTED FASTENER.
 PULLOUT & PULL OVER VALUES ARE DETERMINED IN THE ST FASTENING SYSTEMS ENGINEERING LABORATORY USING STEEL PANELS/FRAMING & WOOD DENSITIES WHOSE STRUCTURAL PROPERTIES ARE FOUND IN PRESENT DAY PRODUCTS.

SIZE	CARTON QTY.	WEIGHT/M
12-24 x 1-1/4"	2500	12.6
12-24 x 1-1/2"	2000	16.2
12-24 x 2"	1500	22.1

PULL OUT STRENGTH LBS. ULT.

SUBSTRATE	GAUGE	THICKNESS	VALUE
HRS PRIMED ONLY	16	.060	
HRS PRIMED ONLY	14	.075	924
HRS PRIMED ONLY	12	.105	1627
AZ55 Galvalume	26	.018	
AZ55 Galvalume	24	.024	
AZ55 Galvalume	22	.030	
AZ55 Galvalume	18	.048	
G90 Galvanized	20	.036	
G90 Galvanized	18	.048	
G90 Galvanized	16	.060	
G90 Galvanized	14	.075	
G90 Galvanized	12	.105	
HRS Plate	3/16"	.167	2556
HRS Plate	1/4"	.250	3298

PULL OVER STRENGTH LBS. ULT.

SUBSTRATE	GAUGE	THICKNESS	VALUE
AZ55 Galvalume	29	.014	
AZ55 Galvalume	26	.018	801
AZ55 Galvalume	24	.024	996
AZ55 Galvalume	22	.030	1258
G90	20	.036	
Aluminum	21	.028	
Slot Edge Panel	29	.014	

NOTES

1. HRS (Hot Rolled Steel)
2. Pull over values calculated with EPDM rubber washer assembled to cupped head screw with .555" washer face.
3. All strength values shown are ultimate values, express in LBS. Apply an appropriate safety factor to obtain design limits.

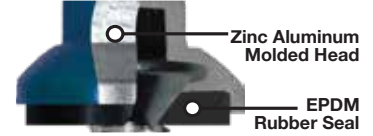

The Zinc-Aluminum alloy HWH prevents red rust from ever starting. ST Fastening Systems spring retainer sockets are recommended. ST Fastening Systems sockets are designed to allow for the added thickness of the powder coat.



Sharp drill point & long flute length assures proper clearance of heavy gauge metal before any thread engagement begins.



No Red-Rust Guaranteed!

SELF DRILL POINT

HEAD STYLE	HWH
POINT DIAMETER	.199/.195
MAJOR DIAMETER	.215/.209
MINOR DIAMETER	.164 REF.
WASHER FACE DIAMETER	.432/.398
HEAD ACROSS FLATS	NOM .312"
NOM. TENSILE STRENGTH	2803 LBS.
MIN. TORSIONAL STRENGTH	100 IN-LBS.
NOM. SHEAR STRENGTH	1999 LBS.

Applications

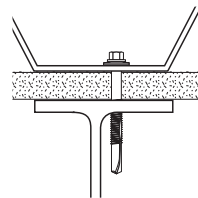

WWW.STFASTENINGSYSTEMS.COM A Division of The Hillman Group

6357 Reynolds Road Tyler, Texas 75708 | P.O. Box 4515, Tyler, Texas 75712 | 800-352-4864 | 800-352-3940 Fax
 9650 Princeton Glendale Rd. Cincinnati, OH 45246 | 800-944-8920 | 800-352-3940 Fax
 Copyright 2017 © ST Fastening Systems, Division of The Hillman Group. All rights reserved.